

1 Sir Wilfred Grenfell Elementary School Seismic Upgrade

PUBLIC INFORMATION SESSION

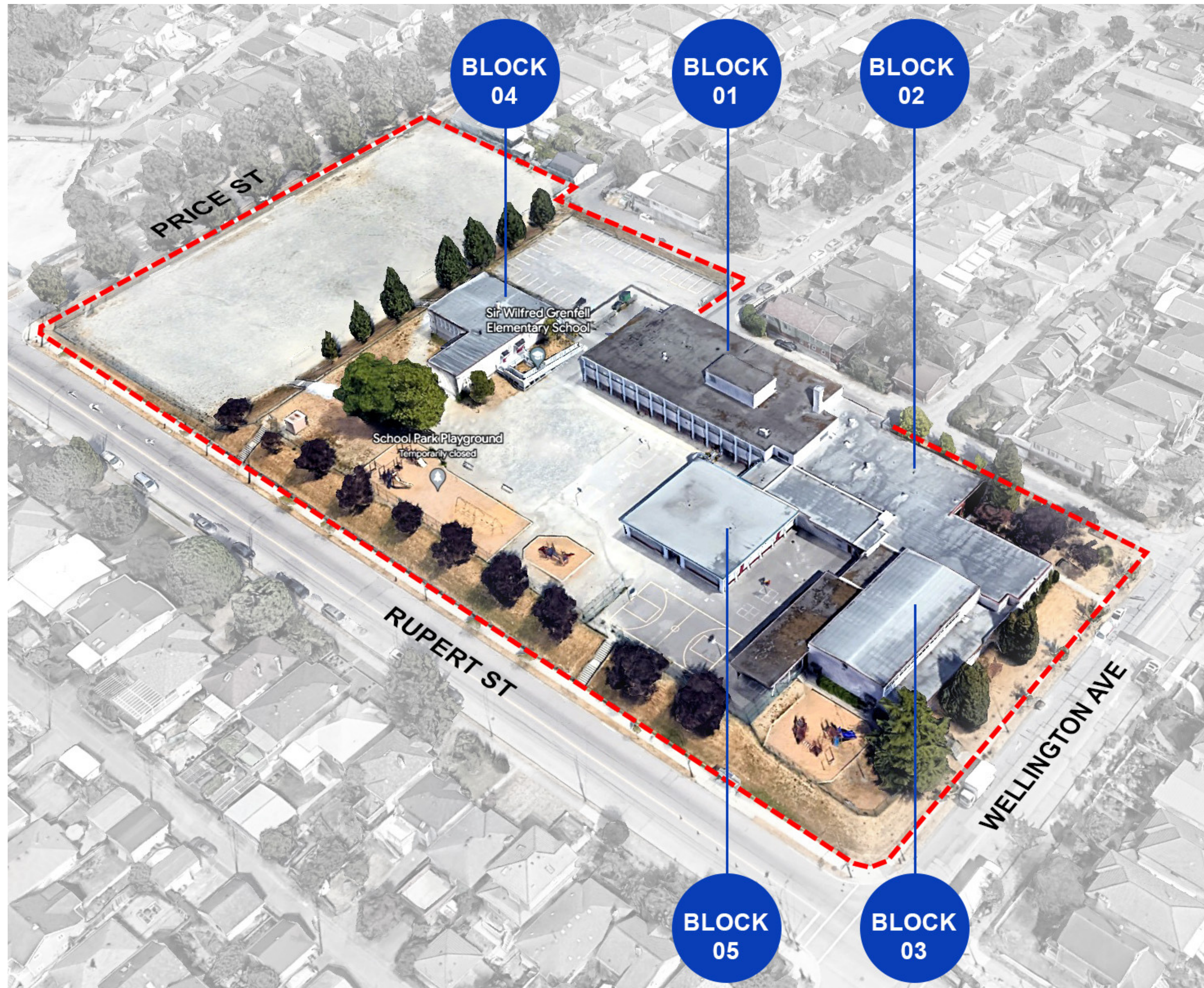

Sir Wilfred Grenfell Elementary School existing site

KEY FEATURES OF THE PROJECT:

- Ensures students attend seismically safe schools as quickly as possible.
- Students and staff will be temporarily accommodated at a swing site, **South Hill swing site** during construction.
- Building components including light fixtures, mechanical and electrical systems will be replaced where impacted by seismic work.
 - Structural upgrades include the foundation and walls.
 - Architectural improvements include new ceiling, floors, where impacted by seismic work. Accessibility improvements such as adding a ramp and elevator to Block 1.*
 - Mechanical improvements will include new piping.
 - Electrical upgrades include replacing electrical systems and installing new lighting.
- Block 04 will be demolished as it is beyond its useful life.

** Work completed under separate funding agreement.*

Anticipated construction start: **Spring 2025**

Anticipated construction completion/move in date: **Fall 2026**

2 Sir Wilfred Grenfell Elementary School Seismic Upgrade

PUBLIC INFORMATION SESSION

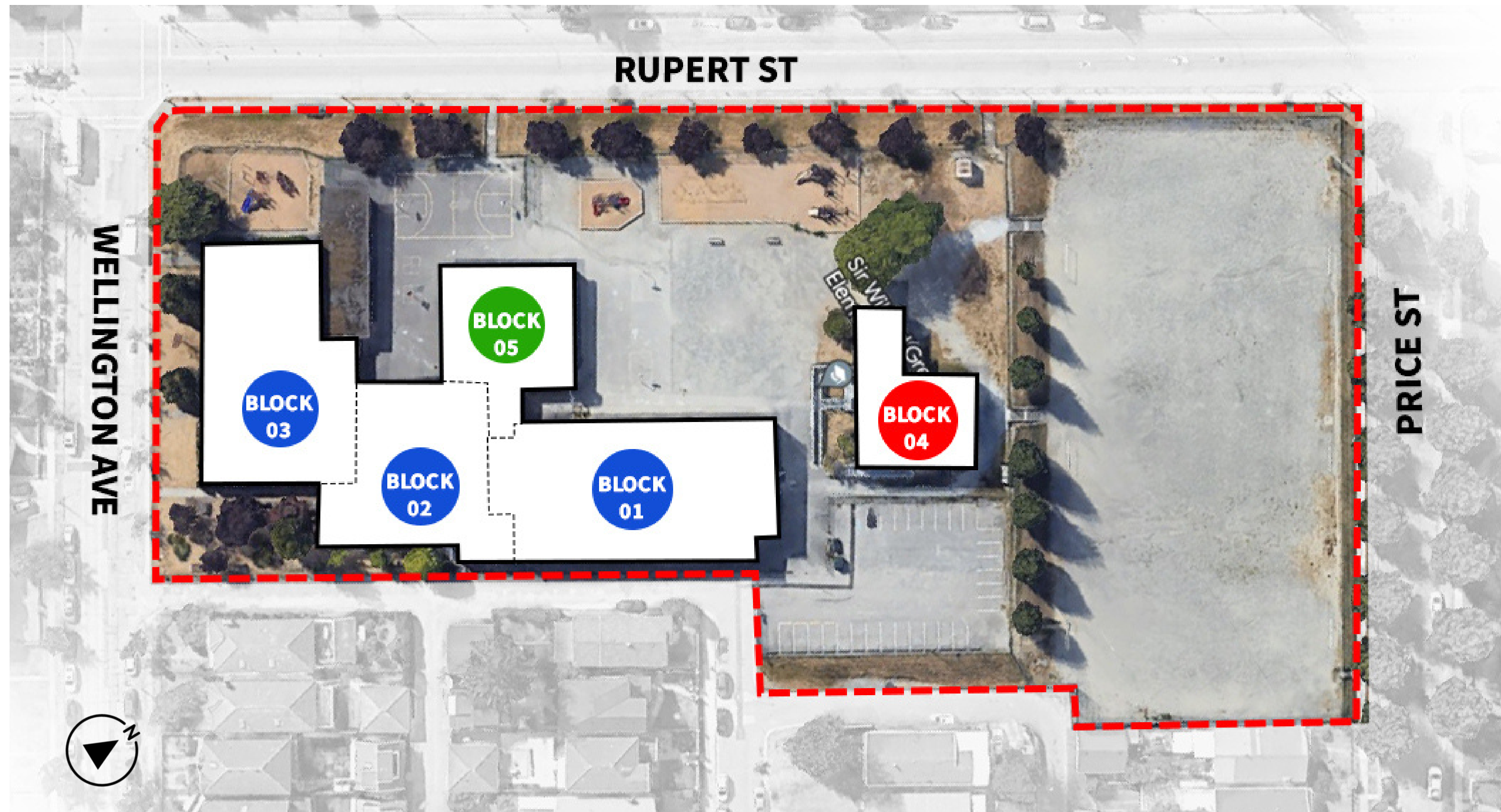

SCHOOL BUILDING HISTORY

- 1910: School originally built (Block 4)
- 1955: Blocks 1, 2 and 3 built.
- 1957: Extension added to Block 1
- 1974: Library addition to Block 2
- 1978: Covered play area to Block 3
- 2002: Block 5 built.
 - This Block **will not be part of this upgrade** as it does not require seismic upgrade.
- The school has served the community well over the years, however the majority of Blocks need seismic upgrades.



Sir Wilfred Grenfell Elementary School existing site

3 Sir Wilfred Grenfell Elementary School Seismic Upgrade

APPROVED OPTION



Gross Area: 4,148 m²
Total Cost: \$29.2M

- Area in **BLUE** is approved for seismic work and funded by the Ministry of Education.
- Area in **GREEN** is not include on the project scope.
- Area in **RED** will be demolished.

Sir Wilfred Grenfell Elementary School existing site

4 Sir Wilfred Grenfell Elementary School Seismic Upgrade

CONSTRUCTION PHASE



WHILE SEISMIC WORK IS UNDERWAY IN 2025-2026:

- Staff and students will temporarily be relocated to **South hill swing site** (please see the following board for more information).
- **StrongStart** (early learning program) will temporarily relocated during construction.
- Traffic patterns will be studied and a traffic management plan will be created to minimize traffic congestion impacts.
- The construction zone will be fenced off to ensure safety for students and community members. The school site and playfield will be closed to the public during construction.
- There will be a parent and student pickup area near the gravel field along Price Street away from the construction zone.

5 Sir Wilfred Grenfell Elementary School Seismic Upgrade

TEMPORARY ACCOMMODATION



SOUTH HILL SWING SITE

5987 Prince Albert Street, Vancouver, BC

- The school has capacity to accommodate all Grenfell students during construction.
- **South Hill** is 5 km (just over a ten-minute drive) from Grenfell.

A transportation plan will be shared with parents by Fall 2024 to the temporary **South Hill** swing site. The plan will include:

- Bus pickup and drop off zones
- Supervision schedules
- School bus expectations



6 Sir Wilfred Grenfell Elementary School Seismic Upgrade

SCOPE OF WORK

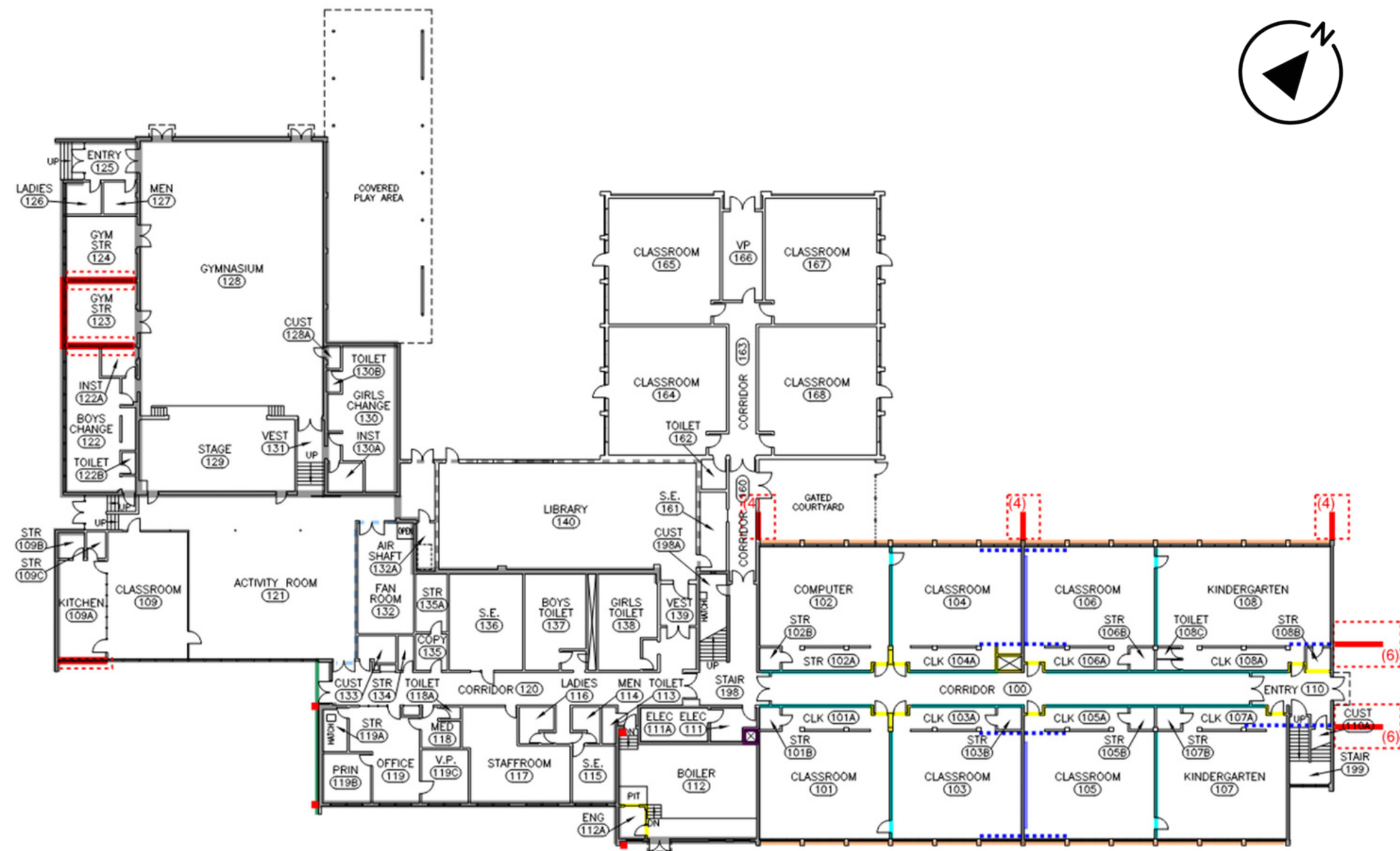

Sir Wilfred Grenfell Elementary School - Ground Floor Plan

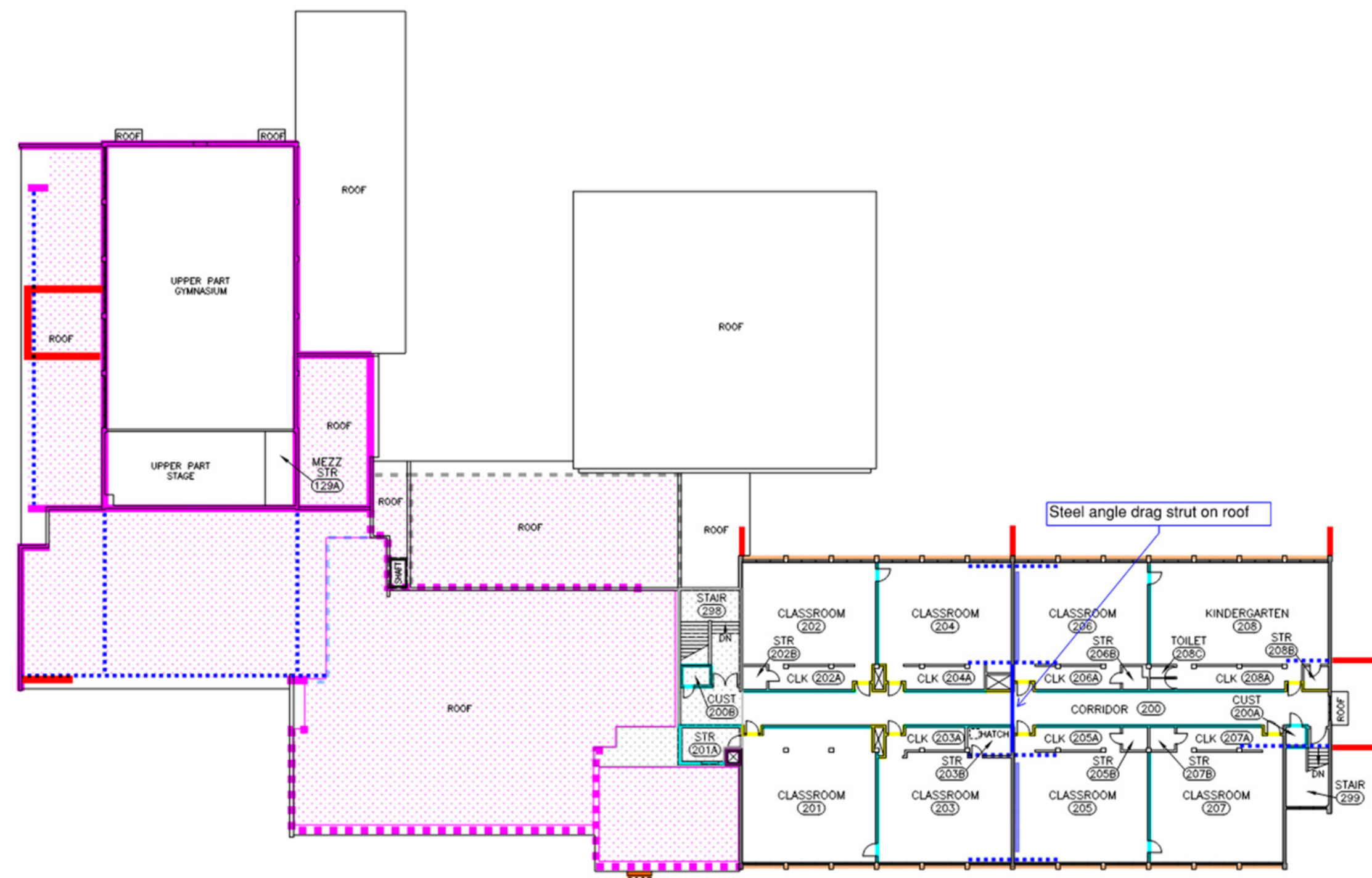

Sir Wilfred Grenfell Elementary School - Second Floor Plan

LEGEND: LIFE SAFETY RETROFIT WORK			
LINE TYPE/COLOR	DESCRIPTION OF WORK	LINE TYPE/COLOR	DESCRIPTION OF WORK
	PROVIDE REINFORCED CONCRETE PILASTER WITH EMBEDDED DYWIDAG SOIL ANCHOR		BRACE EXISTING MASONRY WALL WITH STEEL GIRTS AND POSTS (URM#8)
	PROVIDE REINFORCED CONCRETE SHEAR WALL WITH FOOTING		BENT PLATE TO ATTACH EXISTING WALL TO EXISTING CEILING SLAB
	PROVIDE REINFORCED CONCRETE INFILL AT WINDOW OPENINGS IN EXISTING WALL		STEEL DRAG STRUT ATTACHED TO UNDERSIDE OF CEILING SLAB BAND OR WOOD FLOOR OR ROOF DIAPHRAGM
	PROVIDE 500 mm THICK REINFORCED CONCRETE BUTTRESS WALL AND PILE CAP WITH (n) SOIL ANCHORS (CSW#5)		EXISTING REINFORCED CONCRETE SLAB
	PROVIDE PLYWOOD SHEATHING AT EXTERIOR FACE OF EXISTING WOOD STUD WALLS AND NEW CONCRETE FOUNDATIONS (WSW#1)		PROVIDE PLYWOOD OVERLAY ON EXISTING ROOF DIAPHRAGM
	EXISTING REINFORCED CONCRETE WALL		ANCHOR REINFORCED CONCRETE WALL TO ROOF DIAPHRAGM (BELOW ROOF)
	EXISTING REINFORCED MASONRY WALL		ANCHOR REINFORCED CONCRETE WALL TO ROOF DIAPHRAGM (ABOVE ROOF)
	EXISTING WOOD-FRAMED WALL BETWEEN BLOCKS		REMOVE EXISTING WINDOWS AND GLASS AND CONCRETE BLOCK AND REPLACE WITH NEW ENVELOPE
	ADD MASONRY VENEER TIES		REDUCE HEIGHT OF EXISTING REINFORCED CONCRETE CHIMNEY TO 1.2 m ABOVE ROOF
	REMOVE AND REPLACE EXISTING MASONRY WALL WITH NEW STEEL STUD WALL (URM#1)		BRACE MASONRY CANOPY OVER DOORWAY
	ADD REINFORCING TO EXISTING MASONRY WALLS		

7 Sir Wilfred Grenfell Elementary School Seismic Upgrade

OTHER OPTIONS CONSIDERED

Three other options were studied and considered during the feasibility study, but ultimately not approved.

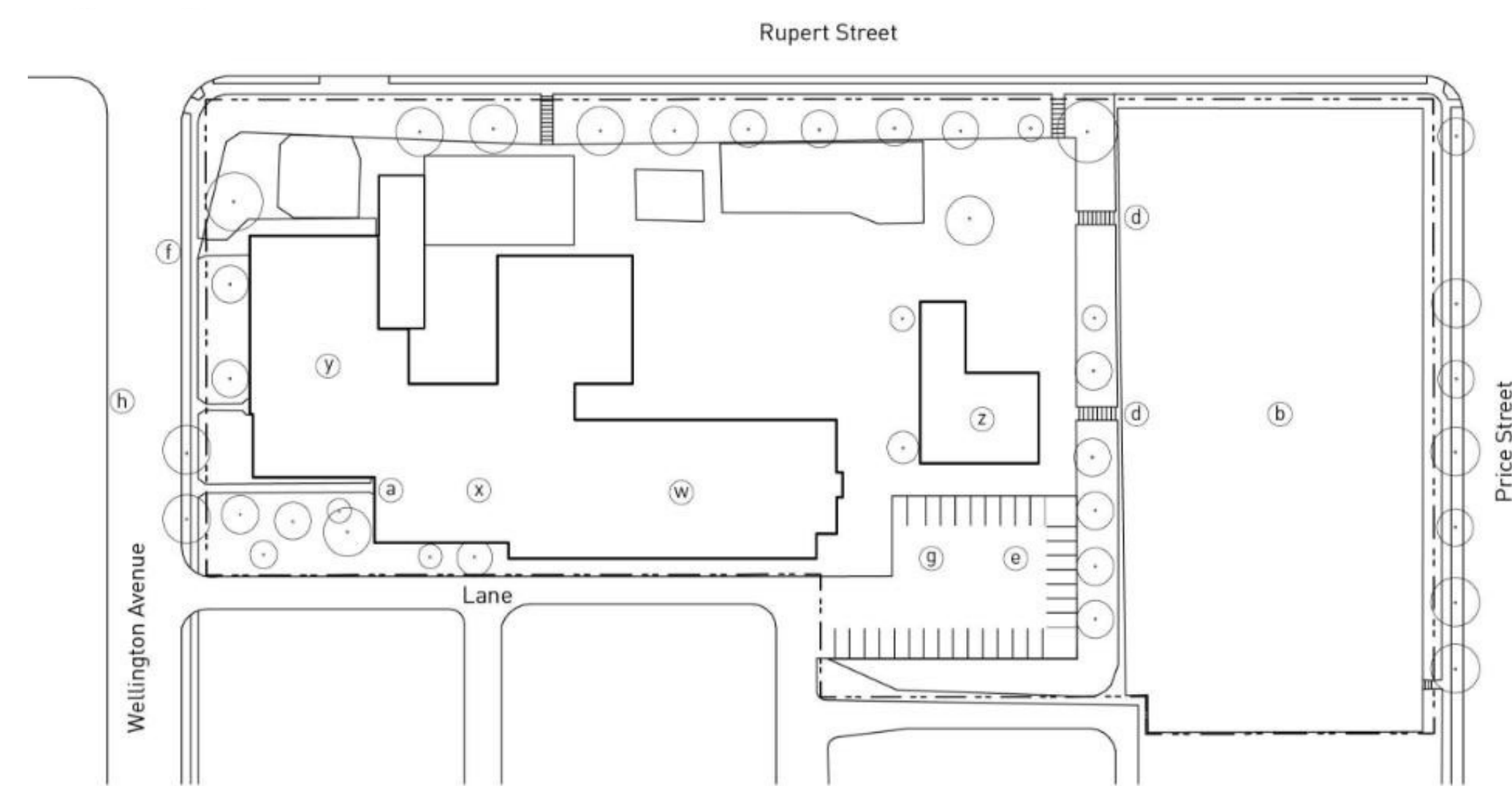

- | Existing to remain | | Seismic upgrades | |
|--------------------|----------------------|------------------|--|
| a main entry | f student drop-off | w block 1 | |
| b playfield | g loading | x block 2 | |
| c playground | h visitor parking | y block 3 | |
| d stairs | i accessible parking | z block 4 | |
| e staff parking | | | |

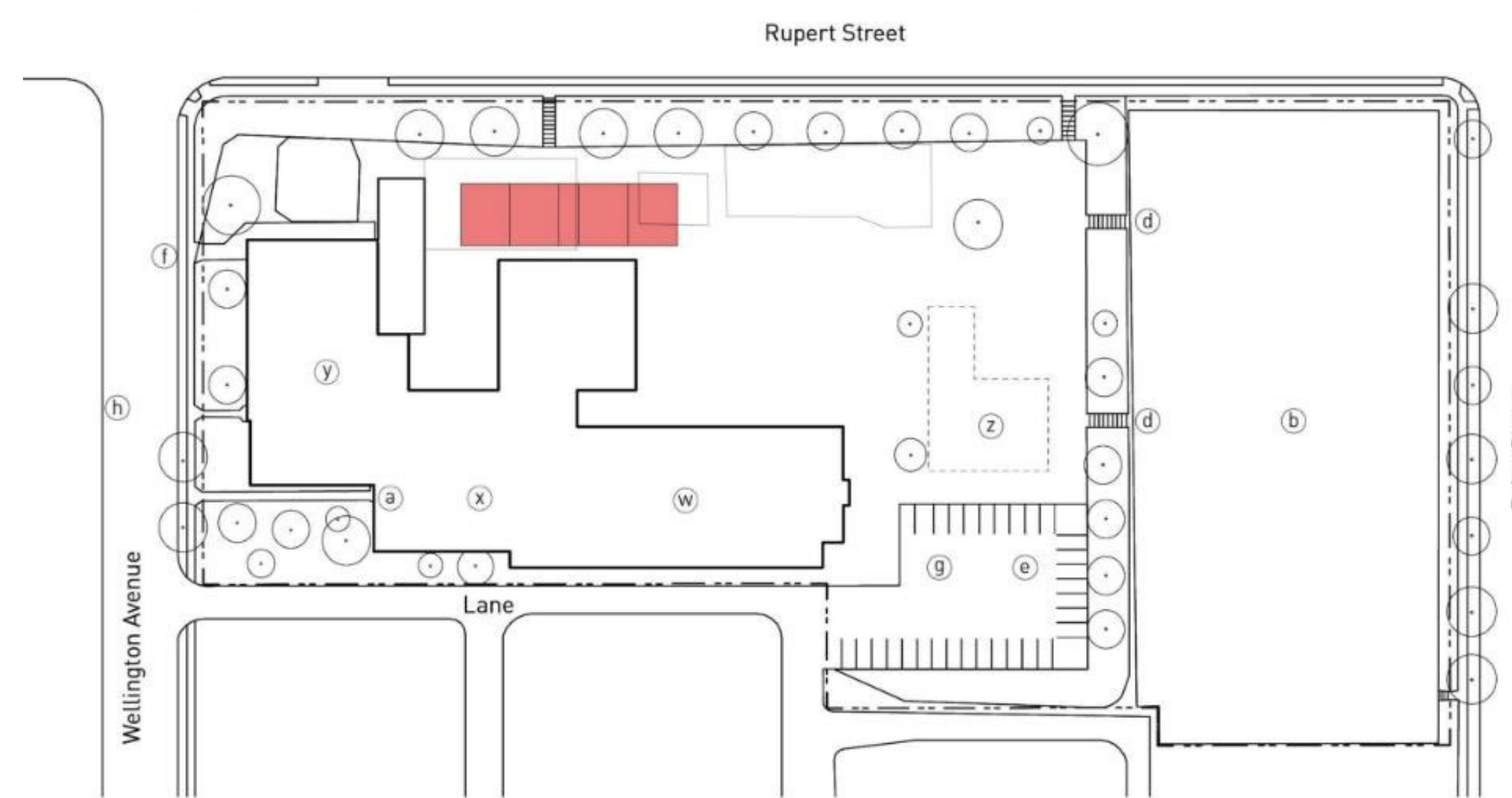

- | Existing to remain | | Seismic upgrades | | New construction | |
|--------------------|----------------------|------------------|--|------------------|--|
| a main entry | f student drop-off | w block 1 | | 11 classrooms | |
| b playfield | g loading | x block 2 | | | |
| c playground | h visitor parking | y block 3 | | | |
| d stairs | i accessible parking | Demolition | | | |
| e staff parking | | z block 4 | | | |

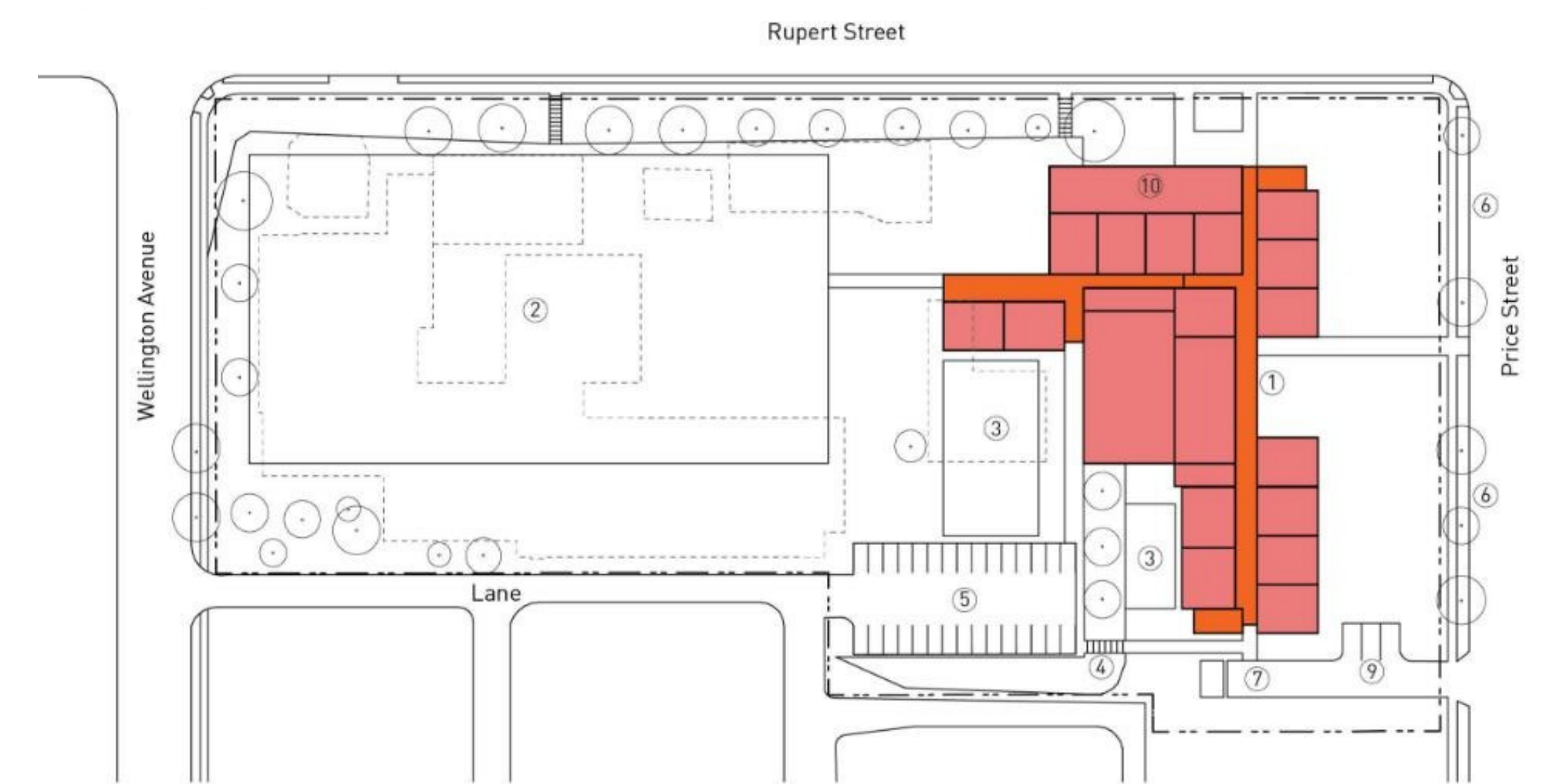

- | New construction | |
|------------------|----------------------|
| 1 main entry | 6 student drop-off |
| 2 playfield | 7 loading |
| 3 playground | 8 visitor parking |
| 4 stairs | 9 accessible parking |
| 5 staff parking | 10 nlc |

- **Option 1 – Seismic Upgrade (alternative)**
- Area: 4544 m²
- Cost: \$32.6M

- **Option 2 – Partial Seismic Upgrade/Replacement**
- Area: 4568 m²
- Cost: \$39.3M

- **Option 3 – Full Replacement**
- Area: 4045 m²
- Cost: \$66.5M

8 Sir Wilfred Grenfell Elementary School Seismic Upgrade

ESTIMATED PROJECT TIMELINE

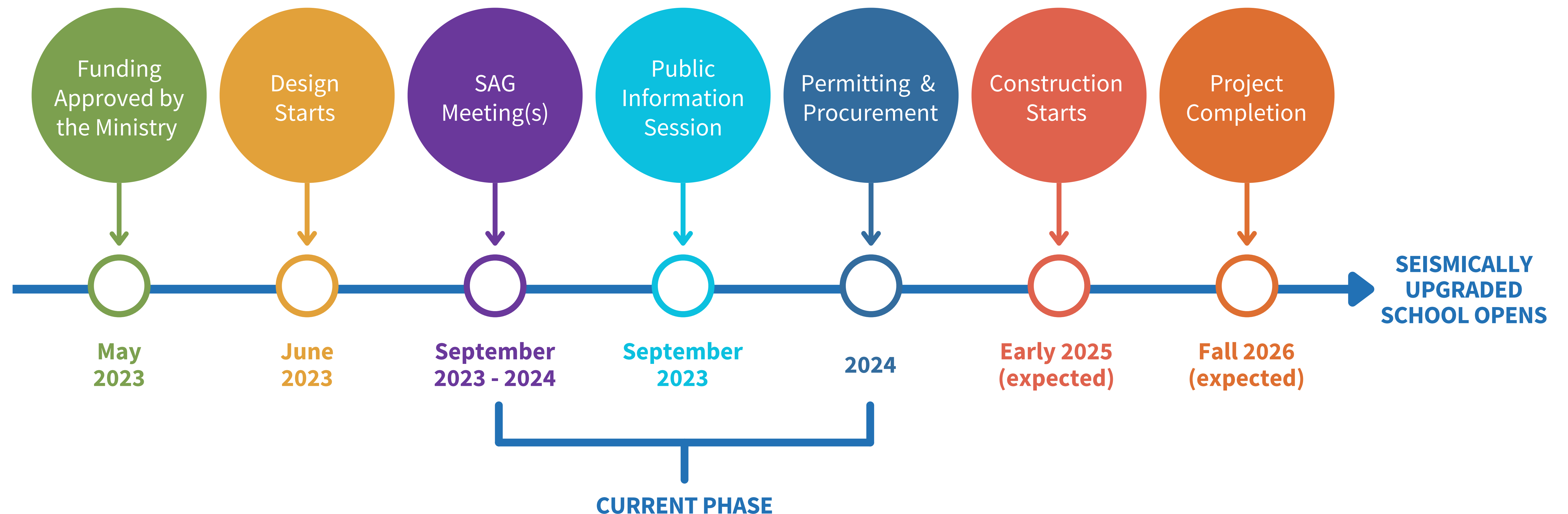

NOTE:

- All dates are subject to approvals from the Vancouver School Board and Ministry of Education and Child Care, as well as City of Vancouver permits.
- The School Advisory Group (SAG) consists of representation from school staff, the PAC, out-of-school care and district staff.

9 Sir Wilfred Grenfell Elementary School Seismic Upgrade

NEXT STEPS

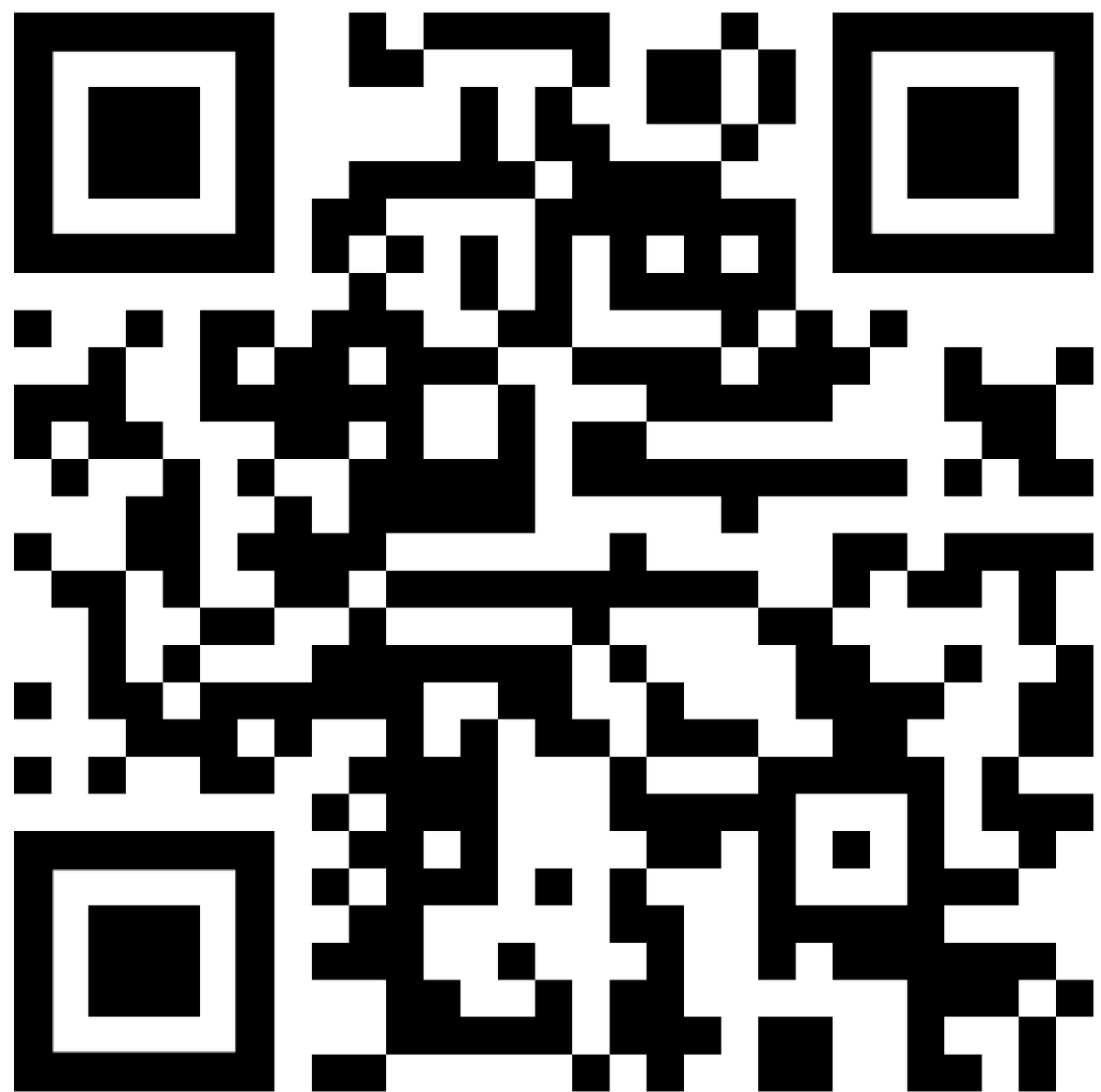

We want to hear from you!

Please see staff to complete a 5-minute survey after reviewing the boards. Your feedback will help inform the seismic upgrade project for **Grenfell Elementary**.

govsb.ca/grenfellseismic

Thank you for attending the public information session.